

**Sample Collection**

**!** Do not eat, smoke, chew or drink any beverages (apart from plain water) for at least 30 minutes before collection.

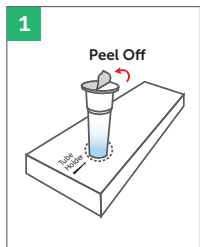

Take out the extraction buffer tube, press and insert it onto the designated tube holder (dotted circle) on the box. Peel off the aluminium seal. *(Be careful not to pour out the liquid)*

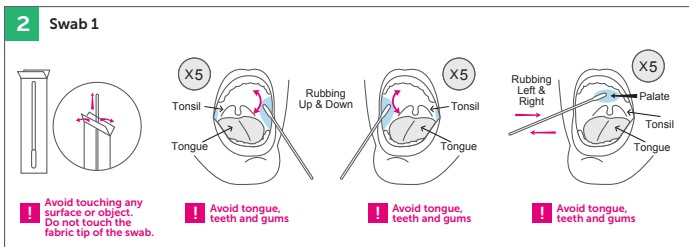

**!** Avoid touching any surface or object. Do not touch the fabric tip of the swab.  
**!** Avoid tongue, teeth and gums  
**!** Avoid tongue, teeth and gums  
**!** Avoid tongue, teeth and gums

- a) Remove one disposable swab from the sterile packaging.
- b) Swab the fabric tip on inside of your left cheek (between the cheek and the gum) by **rubbing up and down** for at least 5 times.
- c) Repeat step b) on the right cheek using the same swab.
- d) Using the same swab, swab the palate for 5 times.

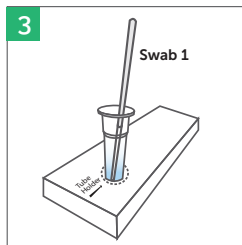

Put swab 1 into extraction tube containing buffer.

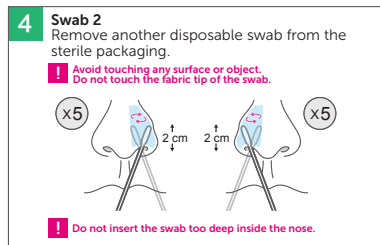

**!** Avoid touching any surface or object. Do not touch the fabric tip of the swab.  
**!** Do not insert the swab too deep inside the nose.

- a) Insert only fabric tip of the swab gently into 1 nostril until you feel a slight resistance (approximately **2 cm** up your nose). Roll the swab around the inside of the nostril, making 5 complete circles.
- b) Repeat step a) above with the other nostril. *(This step can be a little uncomfortable, but it shouldn't be painful.)*

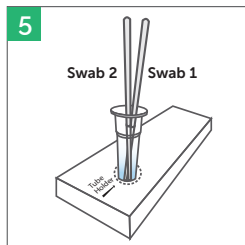

Put swab 2 into the same extraction tube.

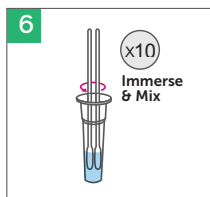

Immerse the swab heads in the extraction buffer completely; vigorously mix at least 10 times.

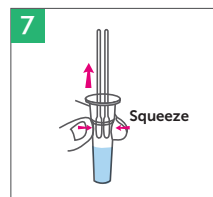

Squeeze liquid from both swabs to **keep the solution in the tube as much as possible** and then discard the swabs.

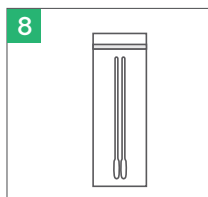

Dispose the used swabs in the waste bag provided and seal the zipper completely.

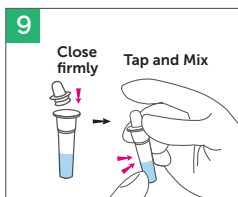

Cover the tube with dripper head firmly, tap the tube and mix the sample solution thoroughly.

**Assay Procedure**

Testing should be performed immediately after the specimen has been collected. Do not expose the specimen at room temperature for prolonged period. Samples are stable up to 30 mins when kept in the extraction buffer provided with the test kit.

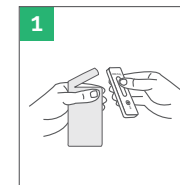

Gently tear open the pouch and remove the test cassette.

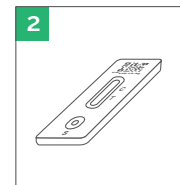

Lay the cassette on a clean, flat work surface. Label the test cassette with sample name.

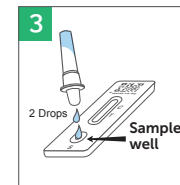

Add 2 drops (~50µl) of the sample solution to the sample well. Make sure there is no air bubble. Sample will start wicking up the membrane.

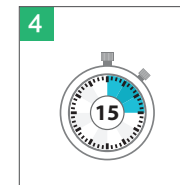

Read results within 10-15 minutes.

**!** Do not interpret results after 15 minutes. Not following this procedure can lead to inaccurate results.

**Result Interpretation**

**Positive for SARS-CoV-2**



Two (2) coloured bands appear, one at the control line (C) and one at the test line (T). Look closely on (T) line. Any visible or faint line indicates positive for SARS-CoV-2 infection.

**What you need to do:** Consult a healthcare professional immediately. Additional molecular testing such as PCR test may be required to confirm your result. Your healthcare professional will determine the best way to care for you, based on the test results along with medical history and symptoms.

You should self-isolate to prevent spreading the virus to others.

**Negative**



Only one (1) coloured band at the control line (C) is visible. This indicates that SARS-CoV-2 virus antigen is not detected. The result does not exclude COVID-19 infection (see the limitations section).

**What you need to do:** If you develop symptoms, please consult your healthcare professional immediately. Additional molecular testing such as PCR test may be required to confirm your result. Your healthcare professional will determine the best way to care for you, based on the test results along with medical history and symptoms.

You must continue to practice social distancing, regular handwashing and wear mask.

**Invalid**



Control line (C) is absent.

**What you need to do:** You should repeat the test by using a new test device.

Scan QR code to refer to tutorial video for Quick User Guide and how to report COVID-19 test result. Your result will be automatically uploaded to MOH via MySejahtera using mySALIXIUM App.

**!** Once your test is completed, put the used test device and buffer tube into the waste bag provided and seal the zipper completely. Keep all of the used test kit contents in a sealed bag and throw in your general household waste. Wash your hands thoroughly for 20 seconds, using soap and warm water, or use hand sanitizer.

