



Scan for more information



Available 24 drugs in variety of formats



No sample preparation required



Fast results in 5 minutes



Easy result interpretation as each drug type is clearly labeled and color-coded



Urine Sample Specimen



Available with adulterant tests



DOA RAPID SINGLE DRUG TEST



100 TESTS
KIT

- 6-Monoacetylmorphine (6-MAM)
- Amphetamine (AMP)
- Barbiturates (BAR)
- Buprenorphine (BUP)
- Benzodiazepines (BZO)
- Carisoprodol (CAR/SOMA)
- Cocaine (COC)
- Erimin (ER5)
- Ethyl Glucuronide (ETG)
- Fentanyl (FYL)
- Synthetic cannabinoids (K2/Spice)
- Ketamine (KET)
- Mitragynine/Kratom (MTG)
- Methamphetamine (MET)
- Morphine (MOP)
- Methadone (MTD)
- Ecstasy (MDMA)
- Oxycodone (OXY)
- Phencyclidine (PCP)
- Propoxyphene (PPX)
- Psilocybin (PY)
- Marijuana (THC)
- Tricyclic Antidepressants (TCA)
- Tramadol (TML)



DOA RAPID DRUG COMBO TEST



25 TESTS
KIT

Able to detect from 2 to 10 different drug combinations at the same time



DOA RAPID DRUG CUP TEST



1 TEST
KIT

- Use a self-contained, one-step closed system with a secure lid to ensure total integrity of urine specimen
- Comes with integrated key activator (no dipping or pouring required)
- Able to detect from 4 to 12 different drug combinations at the same time

IVD

TEST APPLICATIONS

- Pre-employment testing
- Scheduled testing
- Random testing
- Post-accident or for-cause testing
- Treatment follow up testing

For professional *in vitro* diagnostic use only.

MADE IN MALAYSIA

RESZON DOA RAPID SINGLE DRUG TEST

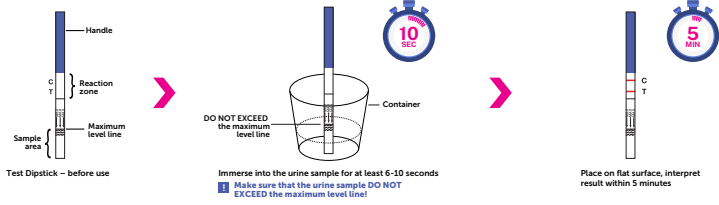

RESZON DOA RAPID DRUG COMBO TEST

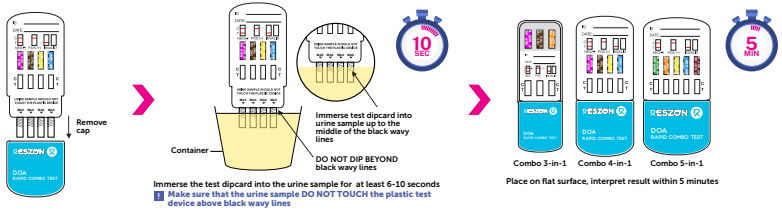

RESZON DOA RAPID DRUG CUP TEST

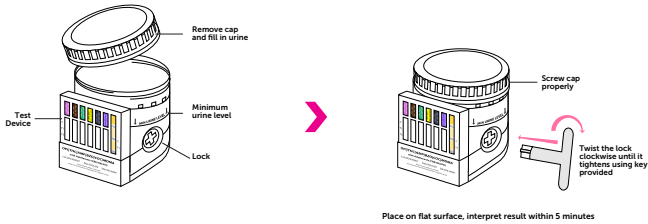

RESULT INTERPRETATION

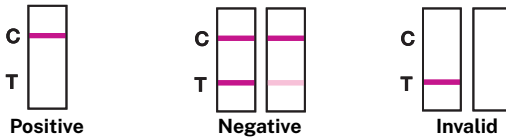

It is recommended that all positive results to be confirmed by using an appropriate analytical technique

RESZON DOA RAPID SINGLE DRUG TEST

Cat. No.	Product Description	Test Specimen	Product Format	Cut Off (ng/ml)	Storage Temp.	Packing Size
RDT-RD-AMP-100	Reszon DOA Rapid, Single Drug Test, AMP (Amphetamine)	Urine	Dipstick	1000	4-30°C	100 T/ Kit
RDT-RD-BAR-100	Reszon DOA Rapid, Single Drug Test, BAR (Barbiturates)	Urine	Dipstick	300	4-30°C	100 T/ Kit
RDT-RD-BUP-100	Reszon DOA Rapid, Single Drug Test, BUP (Buprenorphine)	Urine	Dipstick	10	4-30°C	100 T/ Kit
RDT-RD-BZO-100	Reszon DOA Rapid, Single Drug Test, BZO (Benzodiazepines)	Urine	Dipstick	300	4-30°C	100 T/ Kit
RDT-RD-CAR-100	Reszon DOA Rapid, Single Drug Test, CAR (Carisoprodol / SOMA)	Urine	Dipstick	1000	4-30°C	100 T/ Kit
RDT-RD-COC-100	Reszon DOA Rapid, Single Drug Test, COC (Cocaine)	Urine	Dipstick	150	4-30°C	100 T/ Kit
RDT-RD-ER5-100	Reszon DOA Rapid, Single Drug Test, ER5 (Erimin)	Urine	Dipstick	300	4-30°C	100 T/ Kit
RDT-RD-ETG-100	Reszon DOA Rapid, Single Drug Test, ETG (Ethyl Glucuronide)	Urine	Dipstick	500	4-30°C	100 T/ Kit
RDT-RD-FYL-100	Reszon DOA Rapid, Single Drug Test, FYL (Fentanyl)	Urine	Dipstick	20	4-30°C	100 T/ Kit
RDT-RD-K2-100	Reszon DOA Rapid, Single Drug Test, K2/Spice (Synthetic cannabinoids)	Urine	Dipstick	25	4-30°C	100 T/ Kit
RDT-RD-KET-100	Reszon DOA Rapid, Single Drug Test, KET (Ketamine)	Urine	Dipstick	1000	4-30°C	100 T/ Kit
RDT-RD-MAM-100	Reszon DOA Rapid, Single Drug Test, 6-MAM (6-Monoacetylmorphine)	Urine	Dipstick	10	4-30°C	100 T/ Kit
RDT-RD-MDMA-100	Reszon DOA Rapid, Single Drug Test, MDMA (Ecstasy)	Urine	Dipstick	500	4-30°C	100 T/ Kit
RDT-RD-MET-100	Reszon DOA Rapid, Single Drug Test, MET (Methamphetamine)	Urine	Dipstick	1000	4-30°C	100 T/ Kit
RDT-RD-MOP-100	Reszon DOA Rapid, Single Drug Test, MOP (Morphine)	Urine	Dipstick	300	4-30°C	100 T/ Kit
RDT-RD-MTD-100	Reszon DOA Rapid, Single Drug Test, MTD (Methadone)	Urine	Dipstick	300	4-30°C	100 T/ Kit
RDT-RD-MTG-100	Reszon DOA Rapid, Single Drug Test, MTG (Mitragynine/Kratom)	Urine	Dipstick	300	4-30°C	100 T/ Kit
RDT-RD-OXY-100	Reszon DOA Rapid, Single Drug Test, OXY (Oxycodone)	Urine	Dipstick	100	4-30°C	100 T/ Kit
RDT-RD-PCP-100	Reszon DOA Rapid, Single Drug Test, PCP (Phencyclidine)	Urine	Dipstick	25	4-30°C	100 T/ Kit
RDT-RD-PPX-100	Reszon DOA Rapid, Single Drug Test, PPX (Propoxyphene)	Urine	Dipstick	300	4-30°C	100 T/ Kit
RDT-RD-PY-100	Reszon DOA Rapid, Single Drug Test, PY (Psilocybin)	Urine	Dipstick	500	4-30°C	100 T/ Kit
RDT-RD-TCA-100	Reszon DOA Rapid, Single Drug Test, TCA (Tricyclic Antidepressants)	Urine	Dipstick	1000	4-30°C	100 T/ Kit
RDT-RD-THC-100	Reszon DOA Rapid, Single Drug Test, THC (Marijuana)	Urine	Dipstick	50	4-30°C	100 T/ Kit
RDT-RD-TML-100	Reszon DOA Rapid, Single Drug Test, TML (Tramadol)	Urine	Dipstick	100	4-30°C	100 T/ Kit

RESZON DOA RAPID DRUG CUP TEST

Cat. No.	Product Description	Test Specimen	Product Format	Storage Temp.	Packing Size
RDT-RDC04,05,06,07	Reszon DOA Rapid, Cup 4-in-1 to 7-in-1	Urine	Cup	4-30°C	1 T/ Kit
RDT-RDC10	Reszon DOA Rapid, Multiplex Cup 10-in-1	Urine	Cup	4-30°C	1 T/ Kit
RDT-RDC12	Reszon DOA Rapid, Multiplex Cup 12-in-1	Urine	Cup	4-30°C	1 T/ Kit



For professional *in vitro* diagnostic use only.

MADE IN MALAYSIA

RESZON DOA RAPID DRUG COMBO TEST

Cat. No.	Product Description	Test Specimen	Product Format	Storage Temp.	Packing Size
RDT-RD02,03,04,05,06-25	Reszon DOA Rapid, Combo 2-in-1 to 6-in-1	Urine	Dip card	4-30°C	25 T/ Kit
RDT-RD07,08,09,10-25	Reszon DOA Rapid, Combo 7-in-1 to 10-in-1	Urine	Twin card	4-30°C	25 T/ Kit

RESZON DOA RAPID ADULTERANT TEST

Cat. No.	Product Description	Test Specimen	Product Format	Storage Temp.	Packing Size
RDT-RD06-AD1-25	Reszon DOA Rapid, Combo 6-in-1 with adulterant tests (CRE, OXI, pH)	Urine	Twin card	4-30°C	25 T / Kit
RDT-RD06-AD2-25	Reszon DOA Rapid, Combo 6-in-1 with adulterant tests (SG, NIT, GLU)	Urine	Twin card	4-30°C	25 T / Kit
RDT-RD06-AD3-25	Reszon DOA Rapid, Combo 6-in-1 with adulterant tests (CRE, OXI, pH, SG, NIT, GLU)	Urine	Twin card	4-30°C	25 T / Kit
RDT-RD07-AD1-25	Reszon DOA Rapid, Combo 7-in-1 with adulterant tests (CRE, OXI, pH)	Urine	Twin card	4-30°C	25 T / Kit
RDT-RD07-AD2-25	Reszon DOA Rapid, Combo 7-in-1 with adulterant tests (SG, NIT, GLU)	Urine	Twin card	4-30°C	25 T / Kit
RDT-RD07-AD3-25	Reszon DOA Rapid, Combo 7-in-1 with adulterant tests (CRE, OXI, pH, SG, NIT, GLU)	Urine	Twin card	4-30°C	25 T / Kit
RDT-RD08-AD1-25	Reszon DOA Rapid, Combo 8-in-1 with adulterant tests (CRE, OXI, pH)	Urine	Twin card	4-30°C	25 T / Kit
RDT-RD08-AD2-25	Reszon DOA Rapid, Combo 8-in-1 with adulterant tests (SG, NIT, GLU)	Urine	Twin card	4-30°C	25 T / Kit
RDT-RD08-AD3-25	Reszon DOA Rapid, Combo 8-in-1 with adulterant tests (CRE, OXI, pH, SG, NIT, GLU)	Urine	Twin card	4-30°C	25 T / Kit
RDT-RD09-AD1-25	Reszon DOA Rapid, Combo 9-in-1 with adulterant tests (CRE, OXI, pH)	Urine	Twin card	4-30°C	25 T / Kit
RDT-RD09-AD2-25	Reszon DOA Rapid, Combo 9-in-1 with adulterant tests (SG, NIT, GLU)	Urine	Twin card	4-30°C	25 T / Kit
RDT-RDC04-AD1	Reszon DOA Rapid, Cup 4-in-1, with adulterant tests (CRE, OXI, pH)	Urine	Cup	4-30°C	1 T/ Kit
RDT-RDC04-AD2	Reszon DOA Rapid, Cup 4-in-1, with adulterant tests (SG, NIT, GLU)	Urine	Cup	4-30°C	1 T/ Kit
RDT-RDC04-AD3	Reszon DOA Rapid, Cup 4-in-1, with adulterant tests (CRE, OXI, pH, SG, NIT, GLU)	Urine	Cup	4-30°C	1 T/ Kit
RDT-RDC05-AD1	Reszon DOA Rapid, Cup 5-in-1, with adulterant tests (CRE, OXI, pH)	Urine	Cup	4-30°C	1 T/ Kit
RDT-RDC05-AD2	Reszon DOA Rapid, Cup 5-in-1, with adulterant tests (SG, NIT, GLU)	Urine	Cup	4-30°C	1 T/ Kit
RDT-RDC05-AD3	Reszon DOA Rapid, Cup 5-in-1, with adulterant tests (CRE, OXI, pH, SG, NIT, GLU)	Urine	Cup	4-30°C	1 T/ Kit
RDT-RDC06-AD1	Reszon DOA Rapid, Cup 6-in-1, with adulterant tests (CRE, OXI, pH)	Urine	Cup	4-30°C	1 T/ Kit
RDT-RDC06-AD2	Reszon DOA Rapid, Cup 6-in-1, with adulterant tests (SG, NIT, GLU)	Urine	Cup	4-30°C	1 T/ Kit
RDT-RDC06-AD3	Reszon DOA Rapid, Cup 6-in-1, with adulterant tests (CRE, OXI, pH, SG, NIT, GLU)	Urine	Cup	4-30°C	1 T/ Kit



For professional *in vitro* diagnostic use only.

MADE IN MALAYSIA